

Crawford County

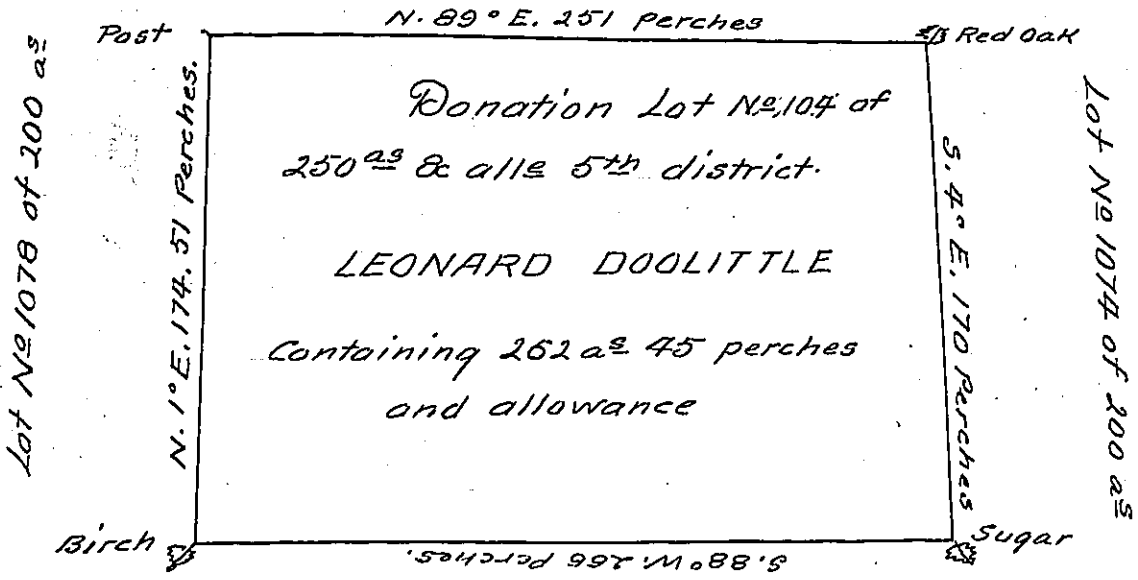

Lot No 1075 of 200 a &

Surveyed the above described land situated in French creek and Deer creek township in Mercer County on the waters of Deer Creek and containing two hundred and sixty two acres forty five perches & allowance about 100 acres improved claimed as an undrawn tract of Donation land as No 104 in the 5th district of 200 acres & allowance and I do hereby certify that from the Survey books and Official documents in my possession the said land as described and applied for has not been surveyed or appropriated to any other person than said applicant or any other person under whom he claims the same.

In witness whereof I have hereto set my hand the 26th day of November A.D. 1851

Wm W. Pearson

To the Surveyor General. — County Surveyor.

IN TESTIMONY that the above is a copy of the original remaining on file in the Department of Internal Affairs of Pennsylvania, made conformably to an Act of Assembly approved the 16th day of February, 1833, I have hereunto set my Hand and caused the Seal of said Department to be affixed at Harrisburg, this twenty eighth day of July 1904

James P. Brown
Secretary of Internal Affairs.